

During 2009, 2010 and 2011, 15 miles of the New York State Thruway (I-90) between Interchange 39 (Syracuse I-690) and Interchange 40 (Weedsport Rt. 34) will be under construction. Upon completion, the \$128 million project will provide a new concrete roadway that will improve rideability and safety.

The project will be constructed in three 5-mile segments (A–B–C) in each direction. The eastbound direction will be reconstructed in 2009. The westbound direction will be reconstructed in 2010. Median work will be completed in 2011. **Two travel lanes in each direction will be provided during peak travel times.** A concrete median barrier will separate eastbound and westbound travel when they are shifted away from the work area.

Delays may occur between Interchange 39 and Interchange 40 from March until November 2009, 2010 and 2011. Motorists can expect construction activity and slower moving traffic during construction periods.

Significant work at Interchanges 39 and 40 is planned. Motorists are asked to exercise caution due to the presence of lane shifts, temporary signals and barriers.

During special events (sporting events, concerts, etc.) traffic is expected to be heavier than normal. Travelers should plan accordingly for possible delays during these events.

The Thruway Authority extends its appreciation to the public for its cooperation during this major reconstruction project.

CONSTRUCTION ZONE INFORMATION

- Motorists are advised that traffic delays may occur during peak travel hours.
- Construction Zones have a reduced speed limit of **55 MPH**. Fines are doubled for speeding in construction areas.
- No shoulders are provided when all traffic is temporarily shifted to one side of the Thruway. Pull-off areas for disabled vehicles as well as emergency service assistance will be provided.
- Warner's Service Area will be open at all times.
- An off-site detour route (following NY Route 31) will be posted in the event of a major traffic incident.
- Lane closures may occur during non-peak hours of travel.
- For more information, call the Thruway's Department of Public Affairs at (518) 436-2983 (24 hrs) or the Syracuse Division Headquarters at (315) 438-2345.

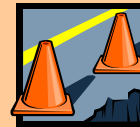

**TO REPORT A
DISABLED VEHICLE, CALL:
1-800-842-2233**

**TO REPORT AN
ACCIDENT, CONTACT THE
NEW YORK STATE POLICE:
911**

NEW YORK STATE THRUWAY AUTHORITY



RECONSTRUCTION OF I-90 INTERCHANGE 39 (Syracuse I-690) to INTERCHANGE 40 (Weedsport Rt. 34)

The Thruway Authority offers free service (TRANSalert) to its customers to inform them of major unscheduled incidents that may affect their travel on the Thruway. TRANSalerts can be received via email or text messaging, and provide subscribers with an incident's specific location, enabling them to better plan their trips on the Thruway. For the most up-to-date information about incidents affecting travel on the Thruway, sign up for the free TRANSalert service by visiting the Authority's website at www.nysthruway.gov

TYPICAL TRAFFIC SHIFT

ALL TRAFFIC MOVED HERE WHILE OPPOSITE SIDE OF THRUWAY IS RECONSTRUCTED.

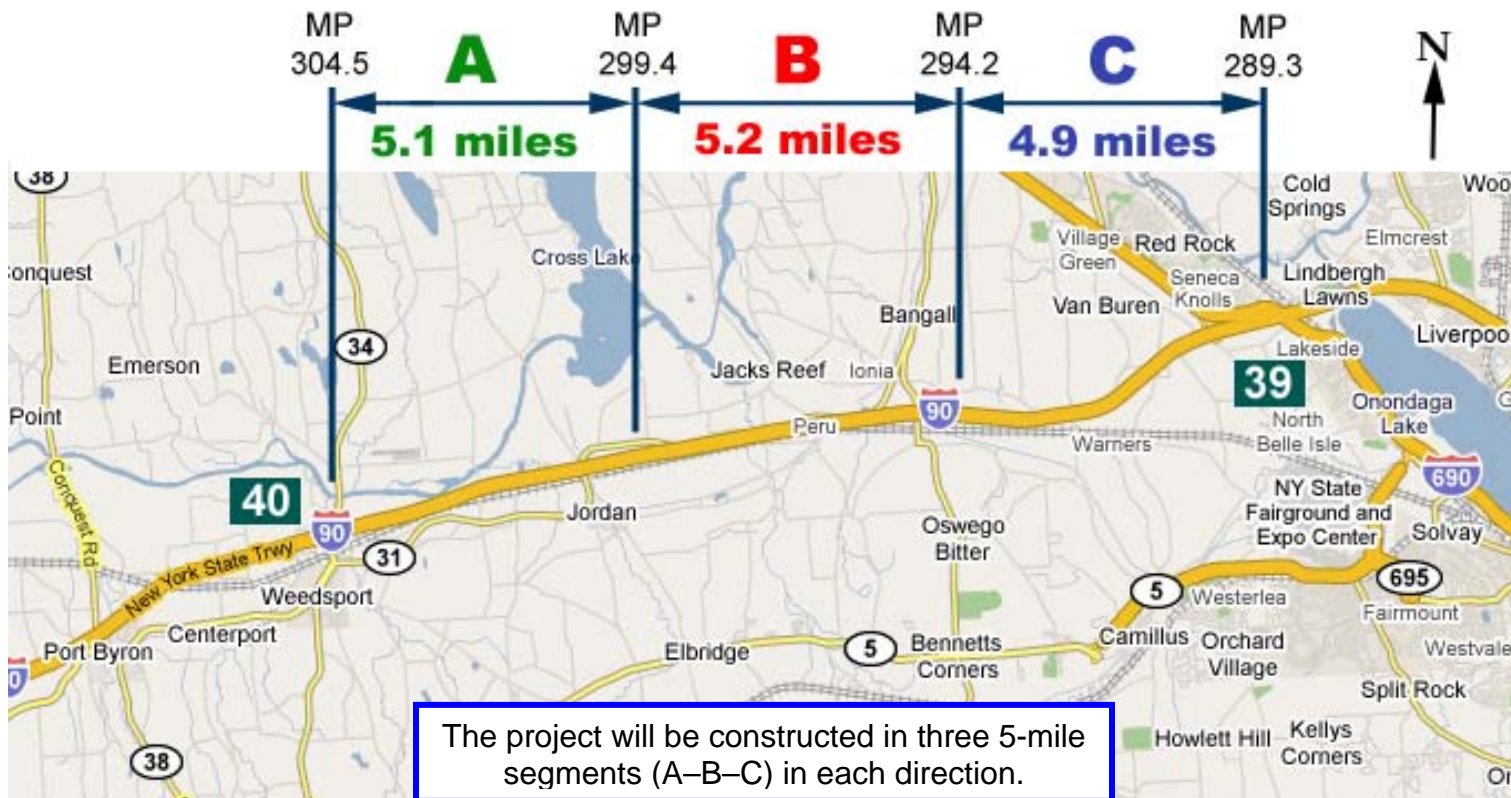
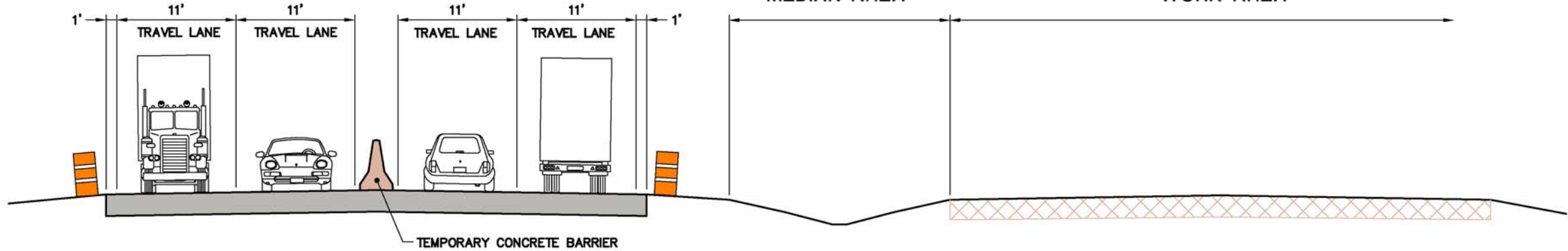

WORK AREA	PLANNED CONSTRUCTION SCHEDULE
EASTBOUND	
B	APRIL - JUNE, 2009
C	JUNE - SEPTEMBER, 2009
A	JUNE - OCTOBER, 2009
WESTBOUND	
B	APRIL - JUNE, 2010
C	JUNE - SEPTEMBER, 2010
A	JUNE - OCTOBER, 2010
EASTBOUND & WESTBOUND	
A	<u>MARCH - AUGUST, 2011</u>
B	PLANNED WORK FOR 2011 WILL BE ACCOMPLISHED WITH SHOULDER CLOSURES AND LANE CLOSURES DURING OFF-PEAK TRAVEL TIMES.
C	
MEDIAN AREA	